

Surgical Technique

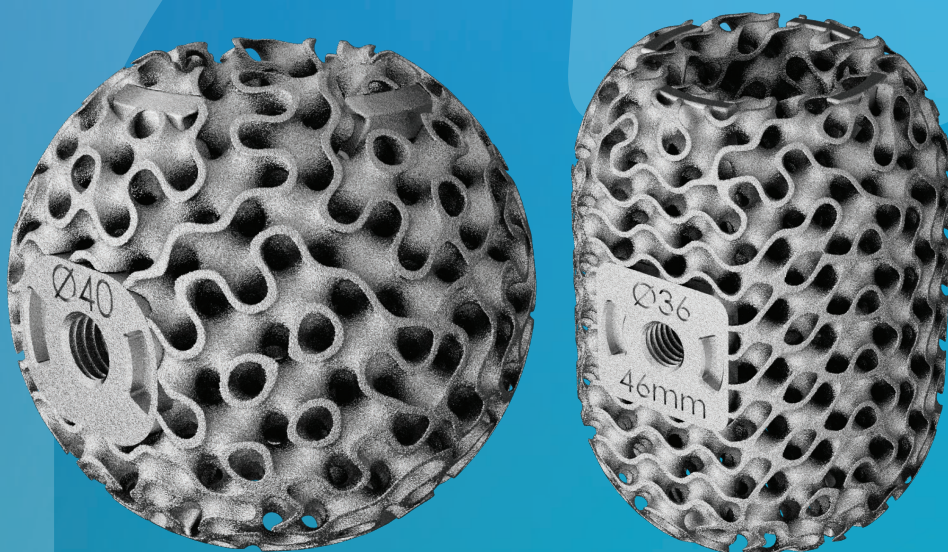

Ossera™ AFX System *Dome and Pill Implants*

restor3d

www.restor3d.com

IMPORTANT NOTE: restor3d, as the manufacturer of this device, does not practice medicine and does not recommend this or any other surgical technique for use on a specific patient. The surgeon who performs any procedure is responsible for determining and utilizing the appropriate techniques for such procedure for each individual patient. restor3d is not responsible for selection of the appropriate surgical technique to be utilized for each individual patient. Always refer to the package insert, product label and/or product instructions prior to using any restor3d product.

For further product information or to arrange a product demonstration, please contact your local restor3d representative or call Customer Service toll-free in the U.S. at (984) 888-0593 or email customerservice@restor3d.com. You can also visit www.restor3d.com.



Table of Contents

Indications for Use	4
Implant Overview	5
Surgical Technique: Dome and Pill Implants	6
Surgical Technique: Removal Implant	10
Ordering Information	11

Indications for Use

Ossera™ AFX System

The Ossera™ AFX System is intended to be used as part of a tibiototalcalcaneal fusion construct in a salvage procedure following failed ankle arthrodesis or failed ankle arthroplasty for patients at risk of limb loss. The Ossera™ AFX System is intended for use as an accessory to the DynaNail TTC Fusion System. The Ossera™ AFX System is not intended for standalone use. The Ossera™ AFX System is intended for use with autograft and/or allogenic bone graft. The Ossera™ AFX System is intended for use with autograft and/or allogenic bone graft.

Implant Overview

The Ossera™ AFX is available in a variety of shapes and sizes, designed to maximize bony contact of the native anatomy and provide a structural element to maintain leg length and promote fusion across a void in a TTC salvage procedure. Each Ossera™ AFX includes a 15mm central cannulation, sized to provide circumferential clearance for the largest diameter DynaNail TTC Fusion Nail, which is a 12mm diameter DynaNail. The Ossera™ AFX features interconnected TIDAL porous structure to provide structural graft containment and promote bony incorporation across the fusion surfaces.

The Ossera™ AFX Dome and Pill implants feature convex proximal and distal surfaces, wherein the distal surfaces are intended to terminate within the body of the talus. The Dome is substantially spherical in shape, while the Pill has convex end sections with an elongated central body. When using the Dome or Pill, the proximal and distal bone surfaces are prepared with a convex reamer, sized to mate with the convex surfaces of the Dome and Pill. Subsequent preparation of the subtalar joint for fusion is required as the implants should not cross the subtalar joint.

Ossera™ AFX implant shape and size selection is dictated by the anatomy, taking into account the amount of bone resected, desired limb length and soft tissue closure. Bone resection should be limited to the affected anatomy to minimize the resulting bone void. The ideal implant will have maximum bony contact on the proximal and distal surfaces while ensuring soft tissue closure may be performed without excessive tension on the soft tissue envelope during closure. Anterior-posterior and medial-lateral implant dimensions should not overhang the cortical margins of the respective bone by more than 2mm in any direction. The Dome and Pill may be used when a concave resection is preferred to minimize the amount of bone removed around the terminal ends.

Surgical Technique: Dome and Pill Implants

1. A direct lateral, anterior lateral or lateral extensile incision is made and dissection is taken down to expose the fibula and the ankle joint complex. Removal of prior hardware may dictate additional incisions.
2. Remove any prior hardware in the vicinity of the fusion that would prevent appropriate reduction or insertion of the Ossera™ AFX and DynaNail construct.
3. If present, perform a fibular osteotomy at the level of the affected anatomy about the ankle joint complex. (fig. 3).



Fig. 3

4. Excise the fibula.
5. Prepare the implantation site using an appropriately sized convex reamer.

NOTE: At final implantation, the distal aspect of the Dome or Pill should terminate in the talus. (fig. 5).

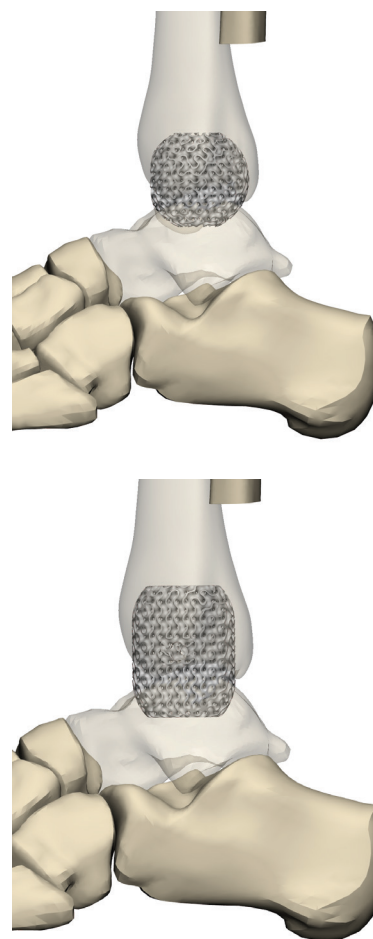

Fig. 5

- 5.1** If using a convex reamer in conjunction with the Dome implant, place 1.6mm guidewire in the center of the desired bone resection. (fig. 5.1). Ream using fluoroscopy to confirm adequate depth and size of the reamer. The reamer may collect bone which can be further used to pack the Ossera™ AFX prior to insertion of the definitive implant. After resecting the affected anatomy, the subtalar surface will require subsequent preparation – per the surgeon’s preferred technique – to remove cartilage and subchondral bone for fusion, as the reamer and implant should not cross the subtalar joint.

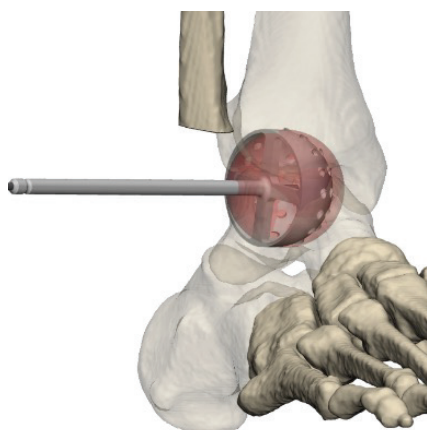

Fig. 5.1

NOTE: It is recommended to begin reaming with the appropriately sized convex reamer for the smallest intended implant size.

- 5.2** If using a convex reamer in conjunction with the Pill implant, place 1.6mm guidewire in the center of the desired proximal bone to be resected. Ream using fluoroscopy to confirm adequate depth and size of the reamer. Remove the guidewire, then repeat the reaming procedure for the distal aspect of the resection. The reamer may collect bone which can be further used to pack the Ossera™ AFX prior to insertion of the definitive implant. After resecting the affected anatomy, the subtalar surface will require subsequent preparation – per the surgeon’s preferred technique – to remove cartilage and subchondral bone for fusion, as the reamer and implant should not cross the subtalar joint.

- 6.** Trials, identically sized to the corresponding implant, are available for each size and shape of Ossera™ AFX offered. Sequential trialing may be performed to assess multiple implant configurations prior to selecting the definitive implant.

- 6.1** If an off-the-shelf trial is used, attach the inserter to appropriate size trial by placing the prongs of the inserter into the corresponding lateral slots in the trial and rotating the knob clockwise while holding the handle. To remove the inserter, rotate the knob counterclockwise while holding the handle.

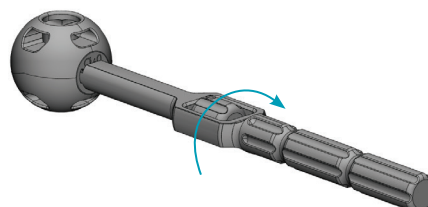

- 6.2** If reaming was performed, the trial footprint should match the reamed anatomy. The trial footprint should provide adequate bone coverage between the trial and anatomy, maximizing cortical bone contact where applicable, without extending beyond the bone margins to avoid interaction with the adjacent soft tissues. The trial height should provide bone contact both proximally and distally to ensure adequate apposition of the Ossera™ AFX to bone. With the trial in place, approximate soft tissue closure to ensure the implant will not require excessive tension on the soft tissue envelope.

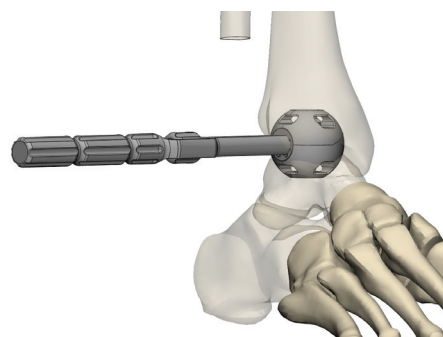

Fig. 6.2

7. Use trial to verify size, shape, and Ossera™ AFX alignment. The ideal implant will maintain the maximum cortical coverage at each end, where possible. Verify alignment of the trial's central hole with the tibial canal under fluoroscopy.
- 7.1 All Ossera™ AFX and respective trials contain a 15mm central through hole that is compatible with all DynaNail IM nail diameters. IM Nail implant selection should be carried out according to the DynaNail Surgical Technique Guide and Instructions For Use. Select the DynaNail of appropriate length to ensure the proximal transverse screws are at least 2cm proximal to the Ossera™ AFX in the tibia, while accommodating for placement of the two distal nail screws in the calcaneus.
8. With the Ossera™ AFX implant trial in place, insert the DynaNail guide wire through the calcaneus and into the tibial canal under fluoroscopy guidance according to the DynaNail Surgical Technique Guide and Instructions For Use, which will determine nail trajectory. Confirm the guidewire is centered within the tibial canal and the trial's central hole in the anterior and lateral views.
9. Retract the guidewire distally from the tibia and trial until the trial can be removed. Remove the trial and insert the guidewire back into the tibia using the prior entry point.
10. Advance the DynaNail reamer in 0.5mm increments, until tibial cortical contact is made, under fluoroscopic guidance to confirm adequate construct alignment and position.

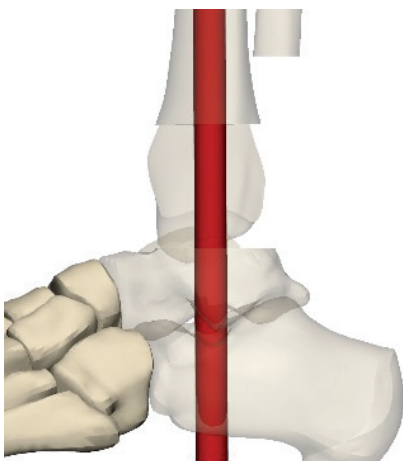

Fig. 10

11. With the definitive Ossera™ AFX implant selected, attach the inserter the Ossera™ AFX by placing the prongs of the inserter into the corresponding lateral slots in the implant and rotating the handle clockwise while holding the outer sleeve (fig. 11). Autograft, allograft or synthetic bone graft material may be packed into the porous lattice and along the circumference of the central hole near each end of the Ossera™ AFX. When the nail is advanced through the central hole of the Ossera™ AFX, the bone graft will help to prevent contact between the Ossera™ AFX and the nail.

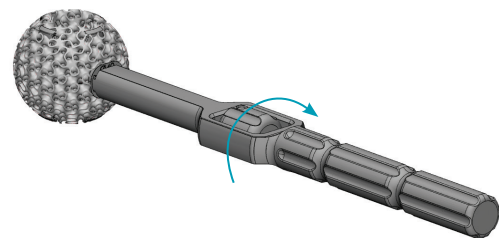

Fig. 11

12. Place the Ossera™ AFX into the surgical site such that the central hole of the Ossera™ AFX is aligned with the reamed tibial canal in the anterior and lateral views as verified under fluoroscopy. Use the inserter attached to the Ossera™ AFX to maintain implant position during nail insertion to minimize contact of the nail with the central hole of the Ossera™ AFX. (fig. 12).

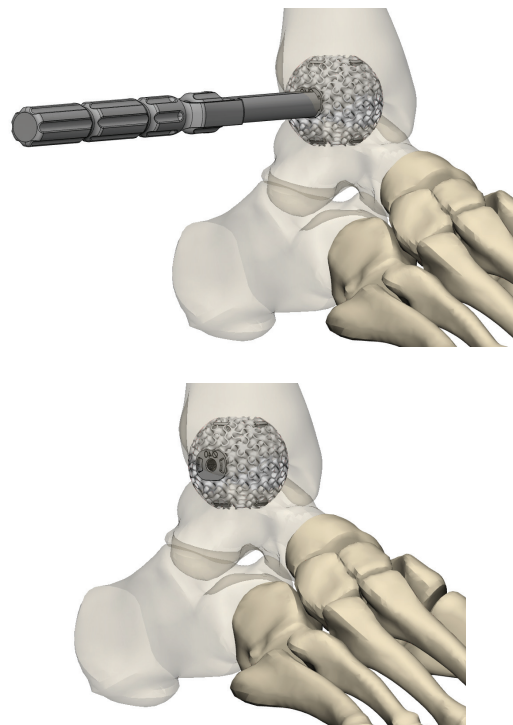

Fig. 12

13. The Ossera™ AFX is indicated for use with the DynaNail TTC Fusion Nail. Follow the manufacturer's Instructions For Use to gradually advance and fixate the DynaNail, taking care, as described above to confirm coaxiality of the DynaNail and the Ossera™ AFX to limit intramedullary contact between the Nail and the Cage. Minor adjustments of the Ossera™ AFX placement may be made using the inserter to position the cage so that it is not contacting the nail. Confirm final alignment in the anterior and lateral views under fluoroscopy. Remove the inserter from the Ossera AFX™ by rotating the handle counterclockwise while holding the outer sleeve.

WARNING: Appropriate surgical technique should be followed to limit contact between the Ossera™ AFX and DynaNail TTC Fusion System construct. Contact between the implants may result in component wear, which could lead to adverse local tissue reactions, implant loosening and osteolysis.

14. Additional bone graft may be placed external to the Ossera™ AFX posteriorly, anteriorly and laterally, as dictated by the patient's anatomy.
15. Close the incision with the surgeon's preferred technique.

Surgical Technique: Removal Implant

16. In the event the implant construct must be removed, remove the fixation screws and DynaNail IM Nail per manufacturer's instructions for use.
17. Osteotomes may be used to loosen the bone-implant interface of the Ossera™ AFX.
18. The inserter may be threaded into the Ossera™ AFX to aid in removal by turning the thumbscrew clockwise (fig. 18).

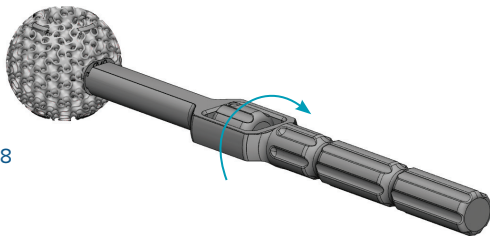

Fig. 18

Ordering Information:

Ossera AFX Dome & Pill Implants – Off The Shelf

PART NUMBER	DESCRIPTION
7000-0010-A	Ankle Cage Implant- Dome, 2 implant options
7000-0010-B	Ankle Cage Implant- Dome, 3 implant options
7000-0010-C	Ankle Cage Implant- Dome, 4 implant options
7000-0040-A	Ankle Cage Implant- Pill, 2 implant options
7000-0040-B	Ankle Cage Implant- Pill, 3 implant options
7000-0040-C	Ankle Cage Implant- Pill, 4 implant options

Ossera AFX Dome & Pill Implants - Off The Shelf

PART NUMBER	DESCRIPTION
1741-3600	Ossera AFX™, Dome, 36D
1741-3800	Ossera AFX™, Dome, 38D
1741-4000	Ossera AFX™, Dome, 40D
1741-4200	Ossera AFX™, Dome, 42D
1741-4400	Ossera AFX™, Dome, 44D
1742-3634	Ossera AFX™, Pill, 36D x 34H
1742-3638	Ossera AFX™, Pill, 36D x 38H
1742-3838	Ossera AFX™, Pill, 38D x 38H
1742-3842	Ossera AFX™, Pill, 38D x 42H
1742-4040	Ossera AFX™, Pill, 40D x 40H
1742-4044	Ossera AFX™, Pill, 40D x 44H
1742-4242	Ossera AFX™, Pill, 42D x 42H
1742-4246	Ossera AFX™, Pill, 42D x 46H
1742-4444	Ossera AFX™, Pill, 44D x 44H
1742-4448	Ossera AFX™, Pill, 44D x 48H

Ordering Information:

Instrumentation

PART NUMBER	DESCRIPTION
7000-0045	Ankle Cage Trial Kit
5801-4111	Sagittal Saw Blade, Conmed
5801-4105	Sagittal Saw Blade, Stryker
5801-0002	Drill Tip K-Wire Kit (Qty 2)
6202-165	Single Trocar Guidewire, 1.6mm x 5"



www.restor3d.com

© 2025. restor3d, Inc. All rights reserved. restor3d and the restor3d logo are registered trademarks of restor3d, Inc.

CAUTION: Federal law restricts this device to sale by or on the order of a physician. Prior to use of a restor3d device, please review the instructions for use and surgical technique for a complete listing of indications, contraindications, warnings, precautions, and directions for use.

LBL-70077 REV 02 NOV2025